

CONTESTER CURVED POP UP SYSTEM

FEATURES AND BENEFITS

- Strong and lightweight aluminium frame to ensure rapid set-up
- Self locating magnetic arms with magnetic studs
- Magnetic studs on header strips to allow precise graphic alignment
- Includes Magnetic Tape
- Hard Wheeled Case
- Deluxe folding wooden top
- Includes LED Light Kit



| PRODUCT DETAILS | | HARDWARE SPECIFICATIONS | | GRAPHIC SPECIFICATIONS |
|---------------------------|------------|--------------------------------|-------------|---|
| Description | Order Code | Dimensions (mm) | Weight (kg) | Dimensions (mm) W x H |
| 3x1-Straight Single Sided | INE185685 | 2225 (h) x 1220 (w) x 300 (d) | 18.0 | 1 Panel—733mm x 2225mm (Front) 2 Panels—673mm x 2225mm (End) |
| 3x2-Curved Single Sided | INE184210 | 2225 (h) x 1600 (w) x 460 (d) | 28.0 | 4 Panels—673mm x 2225mm (Front & End) |
| 3x3-Curved Single Sided | INE185063 | 2225 (h) x 2520 (w) x 685 (d) | 29.0 | 5 Panels — 673mm x 2225mm (Front & End) |
| 3x4-Curved Single Sided | INE185066 | 2225 (h) x 3010 (w) x 960 (d) | 32.0 | 6 Panels — 673mm x 2225mm (Front & End) |
| 3x5 Curved Single Sided | INE185424 | 2225 (h) x 3350 (w) x 1010 (d) | 38.0 | 7 Panels—673mm x 2225mm (Front & End) |
| 3x3-Curved Double Sided | INE184120 | 2225 (h) x 2520 (w) x 685 (d) | 35.0 | 5 Panels — 673mm x 2225mm (Front & End) 3 Panels — 813mm x 2225mm (Rear) |
| 3x4-Curved Double Sided | INE184123 | 2225 (h) x 3010 (w) x 960 (d) | 39.0 | 6 Panels — 673mm x 2225mm (Front & End) 4 Panels — 813mm x 2225mm (Rear) |
| 3x5 Curved Double Sided | INE185436 | 2225 (h) x 3350 (w) x 1010 (d) | 38.0 | 7 Panels—673mm x 2225mm (Front & End) 4 Panels—813mm x 2225mm (Rear) |
| 3x2-Straight Single Sided | INE184213 | 2225 (h) x 1513 (w) x 300 (d) | 28.0 | 2 Panels—733mm x 2225mm (Front) 2 Panels—673mm x 2225mm (End) |
| 3x3-Straight Single Sided | INE184114 | 2225 (h) x 2243 (w) x 300 (d) | 32.0 | 3 Panels — 733mm x 2225mm (Front) 2 Panels—673mm x 2225mm (End) |
| 3x4-Straight Single Sided | INE184117 | 2225 (h) x 2973 (w) x 300 (d) | 36.0 | 4 Panels — 733mm x 2225mm (Front) 2 Panels—673mm x 2225mm (End) |
| 3x3-Straight Double Sided | INE184126 | 2225 (h) x 2243 (w) x 300 (d) | 35.0 | 6 Panels — 733mm x 2225mm (Front & Rear) 2 Panels—673mm x 2225mm (End) |
| 3x4-Straight Double Sided | INE184129 | 2225 (h) x 2973 (w) x 300 (d) | 39.0 | 8 Panels — 733mm x 2225mm (Front & Rear) 2 Panels—673mm x 2225mm (End) |
| Hard Wheeled Case | | | | 795 x 1800 plus overlap |

NOTE: NOTE: PLEASE ALLOW MINIMUM 10mm BLEED ON ALL EDGES

Assembly Instructions

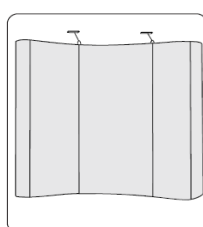
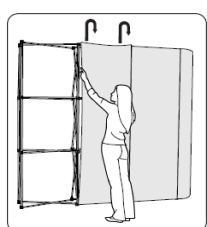
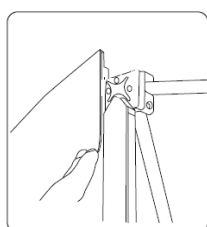
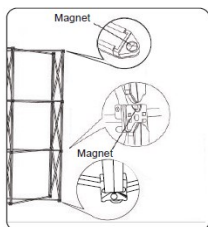
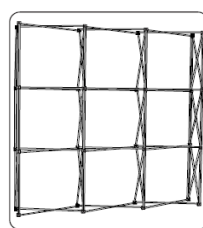
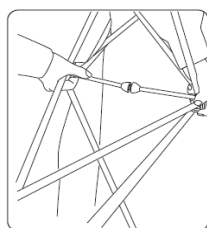
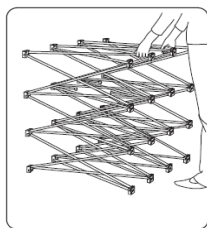

Disassembly Instructions

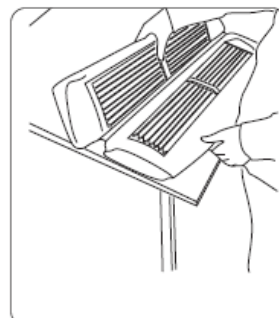
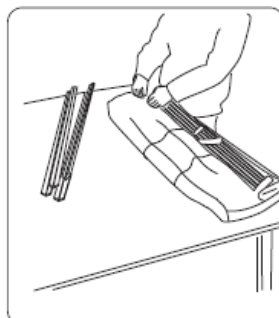
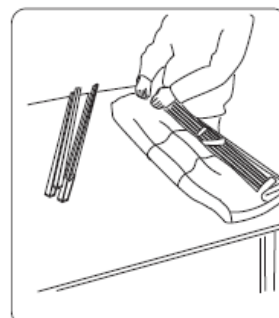
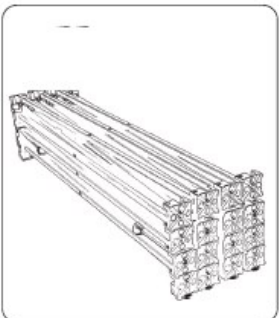
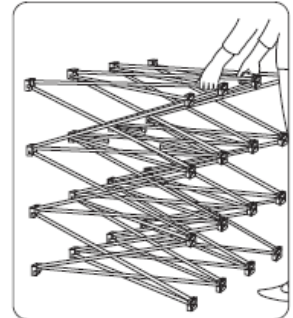
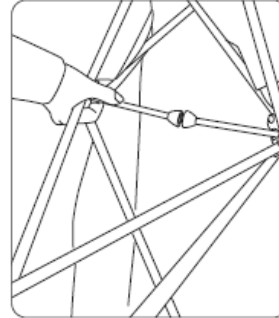
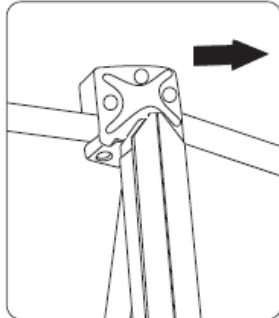
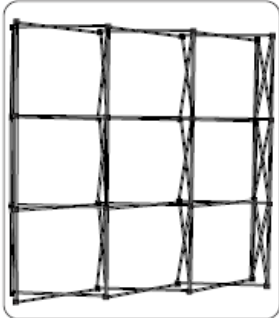
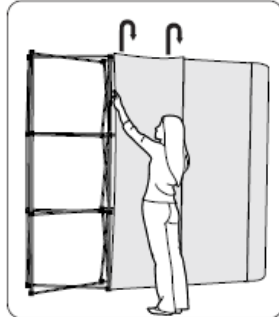
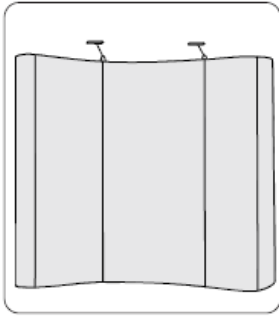

We operate a policy of continuous improvement and we reserve the right to alter products and specifications to reflect this without prior notice. Any information given either verbally or in writing is approximate only and given in good faith and does not constitute terms or part of any contract. We do not accept liability for variance including direct, indirect or consequential loss. The customer is deemed to have determined the suitability of the product for the use intended and assumes all associated risks and liabilities in connection with specifying, using or being unable to use any of the products.